

PRESENTING THE WARDROBE PROGRAMME

SWING DOOR WARDROBE



HEIGHTS:	MODULES:
- 2256	- 425
- 2384	- 475
- 2544	- 575
- 2896	- 875
	- 975
	- 1175
	- Corner
	- End

PRESENTING THE WARDROBE PROGRAMME

COPLANAR SLIDING DOOR WARDROBE

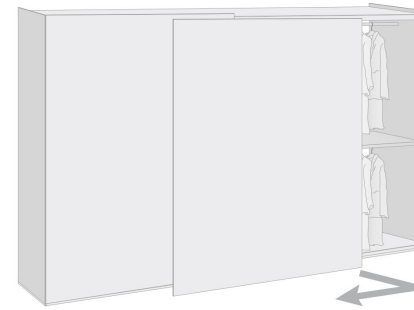

HEIGHTS:	MODULES:
- 2256	- 875 _1 door W. 909
- 2384	- 975 _1 door W. 1009
- 2544	- 1175 _1 door W. 1209
	- 1325 _1 door W. 1359
	- 1475 _1 door W. 1509



wardrobe_W. 1825



wardrobe_W. 2025



wardrobe_W. 2425



wardrobe_W. 2725



wardrobe_W. 3025

SLIDING DOOR WARDROBE

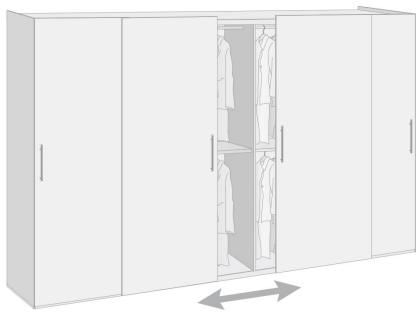

HEIGHTS:	MODULES:
- 2256	- 725 _1 door W. 770
- 2384	- 875 _1 door W. 920
- 2544	- 975 _1 door W. 1020
	- 1175 _1 door W. 1220
	- 1325 _1 door W. 1370
	- 1475 _1 door W. 1520
	- Corner

ALIBI_SWING DOOR

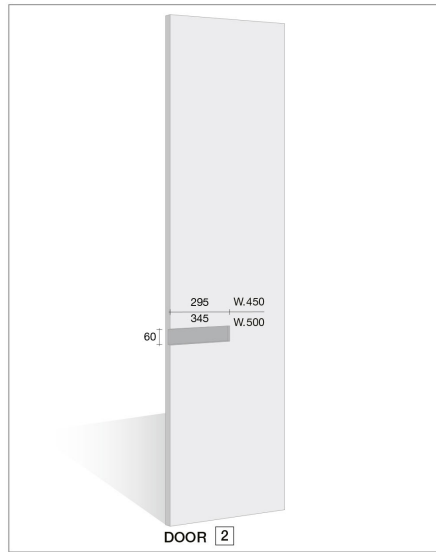
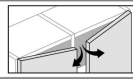

DOOR 2

TECHNICAL FEATURES

The Alibi swing door is composed of:
 - a 26 mm thick MDF panel with a low formaldehyde content
 - a 5 mm thick Handle insert.

**N.B.: NOT AVAILABLE FOR END MODULE
 NOT AVAILABLE WITH A LOCK**

CROSS-SECTION

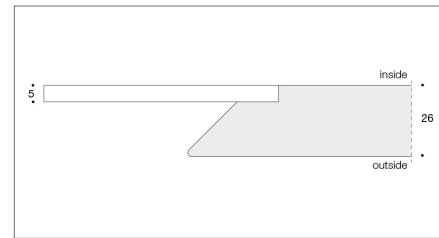

FRONTS



DOOR DIMENSIONS

DOOR TYPES	H. 2256	H. 2384	H. 2544	H. 2896
Swing	W. 450	•	•	•
	W. 500	•	•	•
	W. 600	-	-	-



- = AVAILABLE
 - = NOT AVAILABLE
- CUSTOM-SIZED REDUCTIONS ON PAGE 277

ALIBI_SWING DOOR

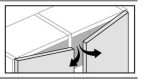

HANDLE INSERT



EXAMPLES OF POSSIBLE POSITIONS OF HANDLE INSERTS

